

12	8x	Helix coil M5	XX	XX		
11	2x	Inbus M5x25	XX	XX		
10	4x	Inbus M5x16	XX	XX		
09	4x	Moer M8	XX	XX		
08	2x	Moer M6	XX	XX		
07	2x	Draad M6x75	XX	XX		
06	2x	Draadend	Messing	XX	XX	
05	4x	Draden isolator	Glas epoxy	XX	XX	
04	4x	Schild	Aluminium	XX	XX	
03	1x	Bovenplaat	Aluminium	XX	XX	
02	1x	Zadel	Aluminium	XX	XX	
01	1x	Grondplaat	Aluminium	XX	XX	
PART NO.	NUM-BER	TITLE	MATERIAL	SIZE/NOTE	I. D. NO./NORM	
Project: LHCB VERTEX DETECTOR						

Title: Overzicht

Scale: 1:2,5
Date: 03-12-'01
Checked: J.C.H.

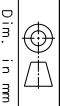

General tolerances unless otherwise stated according to ISO-2768-mK-E
Geometrical tolerances unless otherwise stated according to ISO-8015-E
Roughness unless otherwise stated according to DIN 1302



NATIONAL INSTITUTE FOR NUCLEAR PHYSICS,
AND HIGH ENERGY PHYSICS
P.O.41882,1009 DB Amsterdam, The Netherlands
Visitors: Kruislaan 409, 1098 SJ, Amsterdam
tel: +31-(0)20-5922000
fax: +31-(0)20-5925155

Size: A3
Identification No.: LHCB-TV05
Sheet No.: 1 Number of sheets: 7

