

Section A-A:

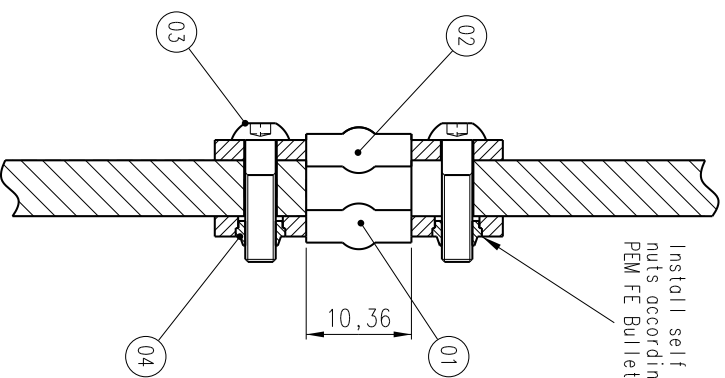
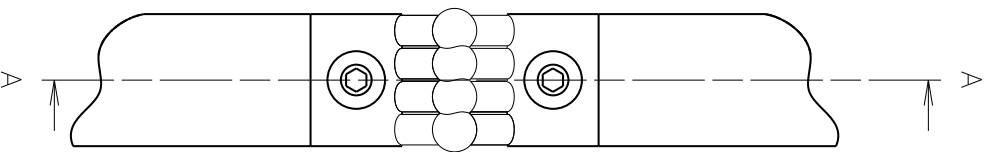

Install self clinching nuts according to PEM FE Bulletin, page FE-6

Torque screws with 50 cN*m

Plane 3 Thermal Bar

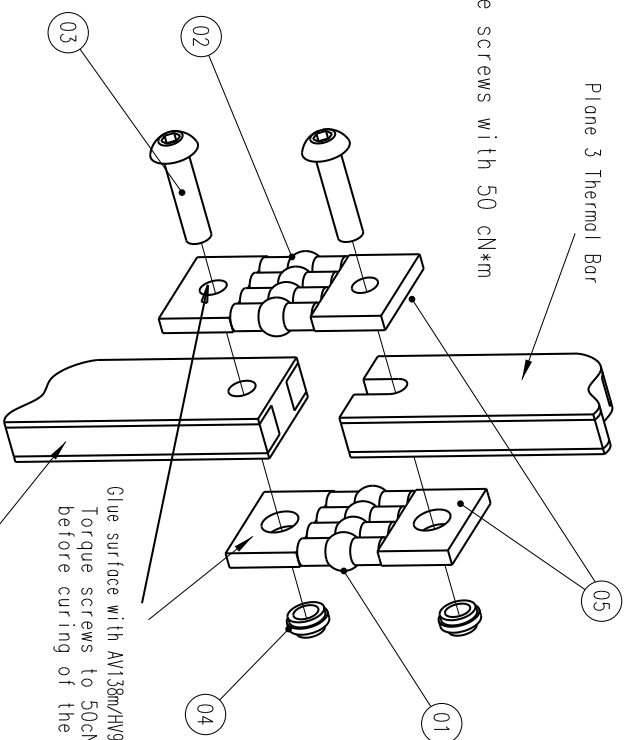

Glue surface with AV138m/AV938 glue
Torque screws to 50cN*m
before curing of the glue

Plane 2 or 4 Thermal Bar

05	2	Thermal Interface Filler		ASD010a	
04	2	M3 Self Clinching Lock nut	GRES 303	PEM-FE-M3-x-EF	
03	2	M3 Sphere Head Screw	GRES316	M3x14 (M3x16) ISO7380	
02	1	Front flex Connector		ASD1002a	
01	1	Rear Flex Connector		ASD1401	
96		Thermal Flex Connector Assy			
PART NO.	NUM-BER	TITLE	MATERIAL	SIZE/NOTE	I.D. NO./NORM
Project: AMS-Silicon Tracker					
Title: Thermal Flex Connector Assembly					

Scale: 2:1	Drawn: B. Verloot	Dim. in mm	General tolerances (flatness) Roughness otherwise stated according to ISO-2768-mK-E ISO-8015-E DIN 3142		
Date: 9-July-2002			Size	Identification No.:	
			A3	ASD14	
NATIONAL INSTITUTE FOR NUCLEAR PHYSICS, AND HIGH ENERGY PHYSICS P.O. 41882, 1009 DB Amsterdam, The Netherlands Visitors: Kruislaan 409, 1098 SJ, Amsterdam Tel.: +31-(0)20-5922000 Fax: +31-(0)20-5925155			Sheet No.:	1	Number of sheets: 1